

SERVOSYSTEM MED BORSTLÖS SERVOMOTOR Ø40-60MM 48V 30-200W

Kompakt Servomotor

R2GA04003F

- Puls styrning
- Extremt kompakta
- 17 bitars pulsgivare
- Hög IP klass IP67



Produktbeskrivning

DC servosystem med borstlös motor i effektstorlekarna 30-200 W.
Mycket hög precision och prestanda.

TEKNISK DATA

Axeldiameter	6 mm
Frontstorlek	40x40
IP-klass	IP67
Längd	51,5 mm
Matningsspänning	48 V DC
Max. moment	0,37 Nm
Nominell hastighet	3000 rpm
Nominellt moment	0,098 Nm
Omgivningstemperatur till	40 °C
Vikt	0,35 kg

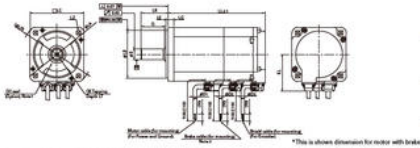

R2 Servo Motor High Efficiency and Low Ripple (Medium Inertia)

MODEL	Battery backup method				L1	L2	L3	L4	L5	L6	L7	L8	L9	L10	L11	L12	L13	L14	L15	
	1	2	3	4																
RS2AM03 ACC	51.5	51.5	51.5	51.5																
RS2AM04 ACC	56.5	56.5	56.5	56.5	0	35.4	48	0	20-0.021	2.5	58	43	2-0.15	25						
RS2AM05 ACC	77	108	77	119																
RS2AM06 ACC	56.5	52.5	55.5	59.5	4	44.4	73	20-0.025		42	40	4-0.15	25							
RS2AM07 ACC	59.5	57.5	70.5	30-0.5						3										
RS2AM08 ACC	69.5	102	79.5	138	8	54.4	90	20-0.025		108	90	4-0.15	30							
RS2AM09 ACC	56.5	122.5	102.5	140.5	8	48.4	79	20-0.025		82	90	4-0.15	30							
RS2AM10 ACC	76.5	114	85.5	121	4	44.4	90	20-0.025		108	90	4-0.15	30							
RS2AM15 ACC	107.5	140	114.5	150	8	59.4	109	20-0.025		135.5	98	4-0.15	30							
RS2AM20 ACC	137	189	157	199	8	59.4	109	20-0.025		135.5	98	4-0.15	30							

MODEL	0	G	DF	LF	DF	DF	DF
RS2AM03 ACC	0						
RS2AM04 ACC	0						
RS2AM05 ACC	0	20					
RS2AM06 ACC	0						
RS2AM07 ACC	0						
RS2AM08 ACC	0						
RS2AM09 ACC	0	140.0	20				
RS2AM10 ACC	0						
RS2AM15 ACC	0	140.0	20				
RS2AM20 ACC	0	140.0	20				

■ Servo Amplifier

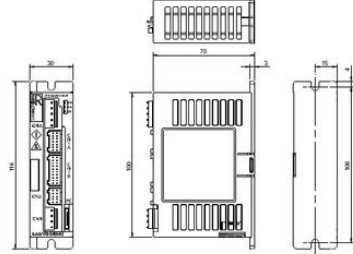

Mass : 0.23kg